



Teacher Dashboard User Guide

**My Dental
Buddy**

Teacher Dashboard User Guide

Dear Teachers,

This tutorial will guide you through the process of setting up the MyDentalBuddy Teacher Dashboard and utilising its features in your everyday Supervised Brushing sessions.

What is the My Dental Buddy Teacher Dashboard?

The My Dental Buddy School Dashboard is designed to make supervised brushing sessions seamless by:

- Providing visual guidance for children to follow along with
- Tracking your daily supervised brushing sessions automatically
- Keeping simple records without extra paperwork
- Making brushing more engaging for children

Best of all, we've made getting started incredibly simple. As a result, you don't need to worry about:

- Understanding complex technology, as the dashboard is designed to be straightforward
- Accidentally breaking anything, as the dashboard is well X
- Remembering lots of steps every time is a breeze after reading this guide!

The tutorial below will guide you through everything and is split into the following parts;

- **Part 1** - Logging in and Accessing Your Dashboard
- **Part 2** - Setting Up Your Class Profile on My Dental Buddy
- **Part 3** - Daily Supervised Brushing Session Setup - Before Brushing
- **Part 4** - Daily Supervised Brushing - Let's Get Brushing!
- **Part 5** - Daily Supervised Brushing: Wrapping Up the Session and Cleaning

PART 1:

Logging in and Accessing Your Dashboard

The first part of the tutorial will guide you through logging in and accessing the My Dental Buddy dashboard.

My Dental Buddy will have sent you an email inviting you to join the particular dashboard for your school. The email will contain a link that allows you to log in to the dashboard directly for the first time.

- Hit “Accept Invitation” on the email:

Welcome to My Dental Buddy!

You've been invited to join ACME Primary

Hello Yasin,

You've been invited to join **ACME Primary** on My Dental Buddy. Click the button below to accept your invitation and set up your account:

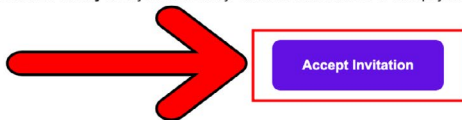

What's next?

- Click the invitation link above
- Set up your password
- Start using DentalBuddy!

This invitation link will expire in 24 hours for security reasons.

If you have any questions, please contact your school administrator.

You will be asked to create a unique password when you log in for the first time.

- Please enter your desired new password and hit “update password”:

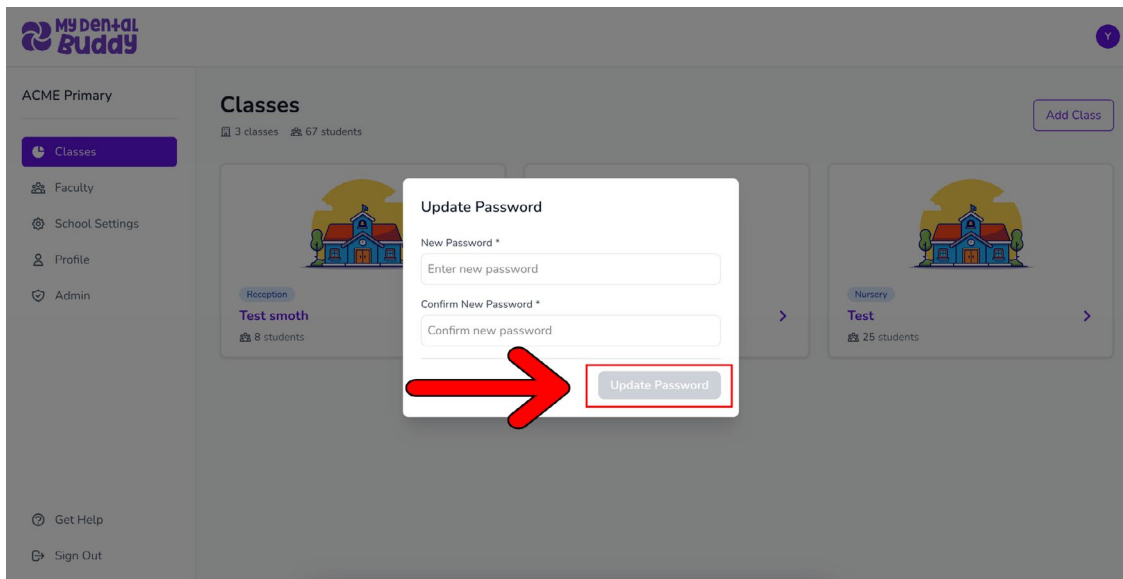

After updating your password, you should see the Classes Page on the Teacher Dashboard:

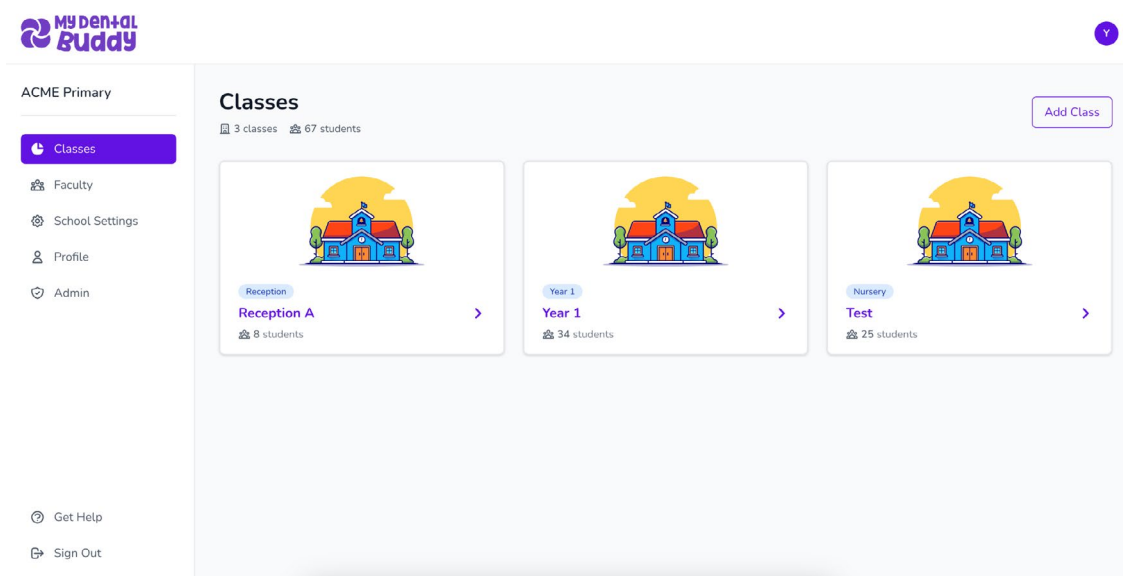

You have now successfully logged into the My Dental Buddy Teacher Dashboard.

After your first login, you can navigate to the My Dental Buddy website to log in directly.

The following steps will guide you through the process of logging in.

- Open up your web browser (Chrome, Safari, Edge - any will work) and head to the following URL;

<https://mydentalbuddy.com/login>

This will bring up the following screen;

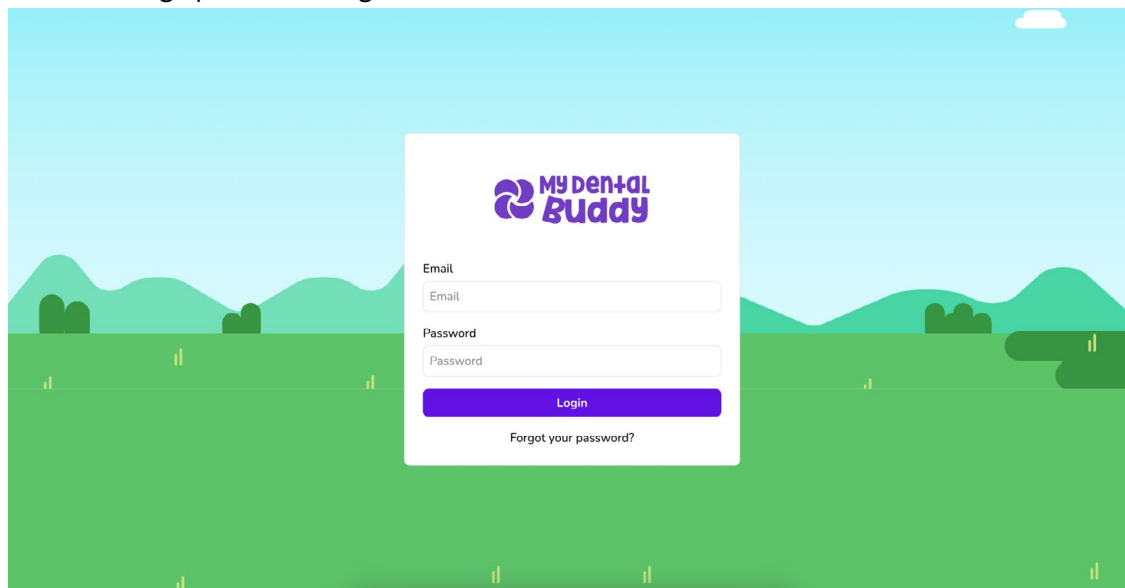

- Enter your login details in the fields provided and hit login.



Having Problems?

- Check your internet connection
- Try refreshing the page
- Contact us if login details aren't working

Part 2: Setting Up Your Class Profile on My Dental Buddy

After logging in, you will be required to set up your class profile. This needs to be done once only.

What you'll need:

- ❑ A Class Name
 - ❑ The Class Year
 - ❑ The Class Size
- On the classes page, hit “Add Class” in the top-right-hand corner:

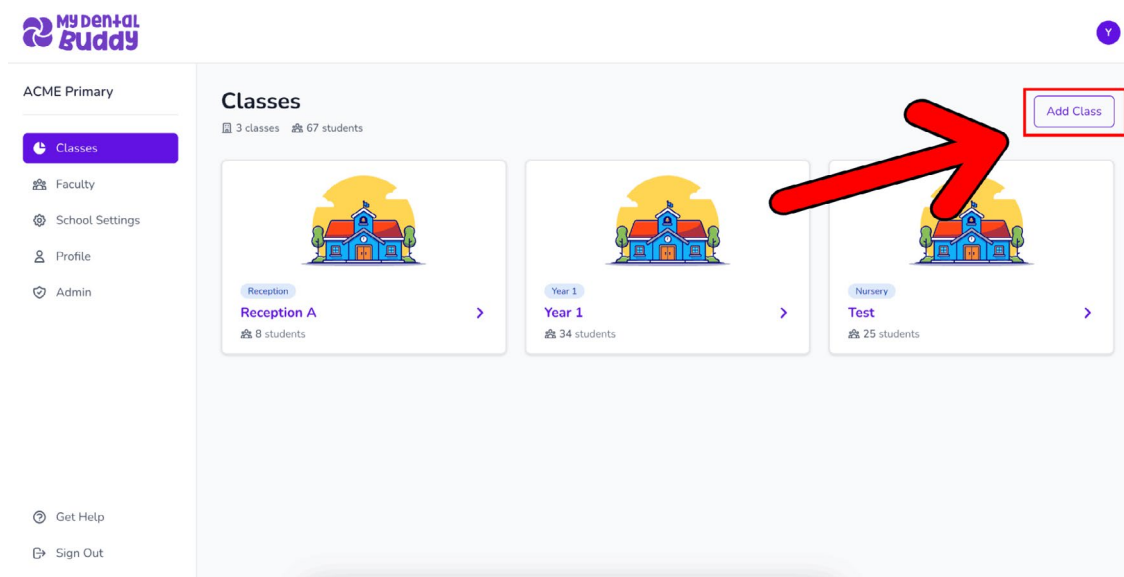

This will bring up a pop-up box, allowing you to enter your class details.

- Please enter your Class Name (for reference), Class Year, and the total number of children in the class overall. Once complete, hit “Add Class”:

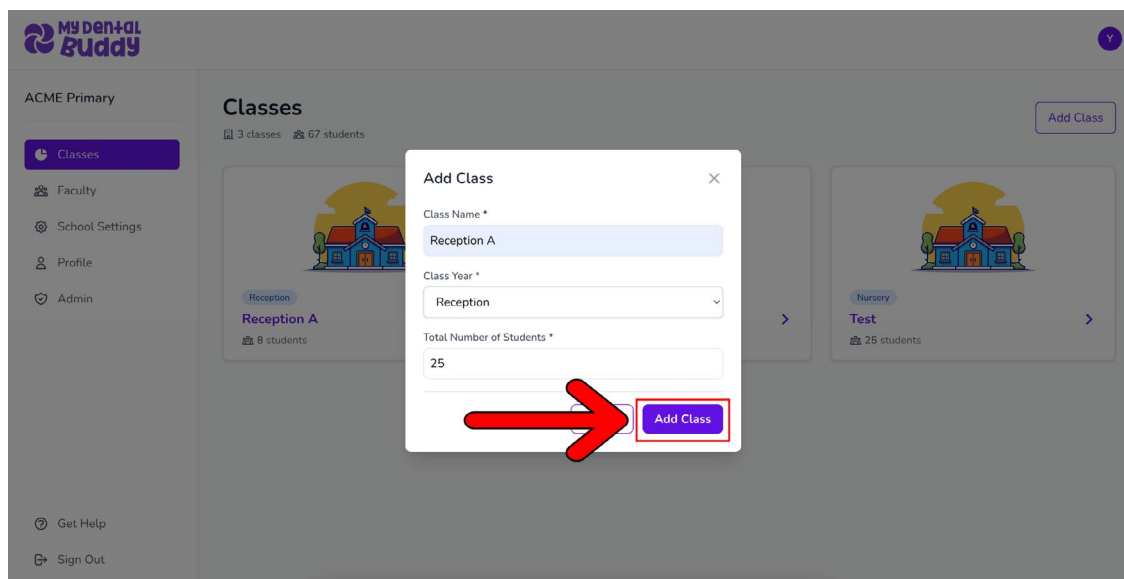

After hitting “Add Class”, you will see your new Class Profile on the Dashboard.

Don't Worry About Getting It Perfect:

- You can change the number of children anytime
- You can edit class details later
- Multiple staff can use the same class account

PART 3:

Daily Supervised Brushing Session Setup - Before Brushing

The following three parts of this tutorial guide you through setting up the supervised brushing, conducting the session, and cleaning up.

Let's start with the setup before the brushing begins.

- Click your class profile from the “Classes” page:

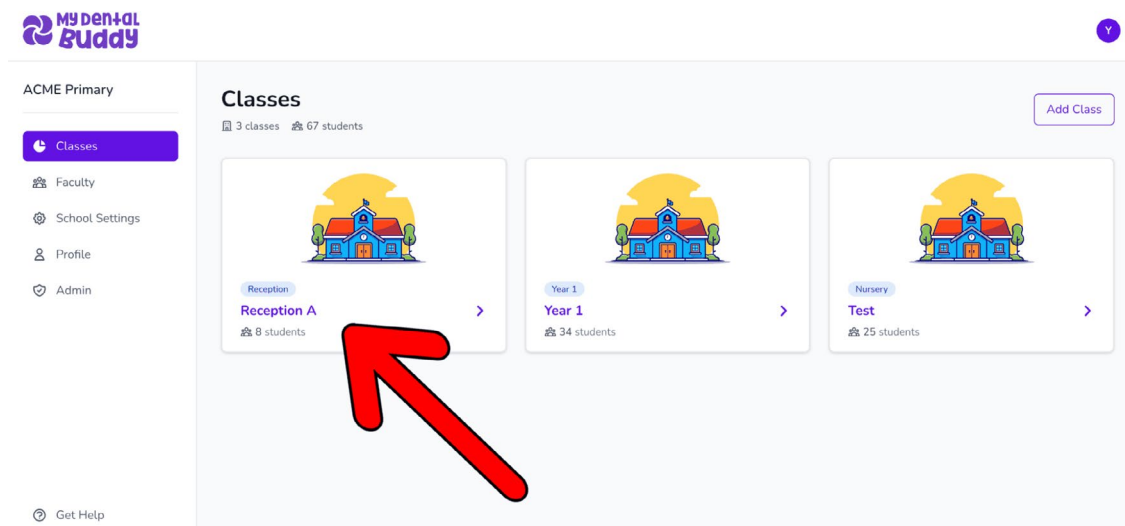

This will bring up the profile for that class.

- Hit “Start Brushing” to begin the session:

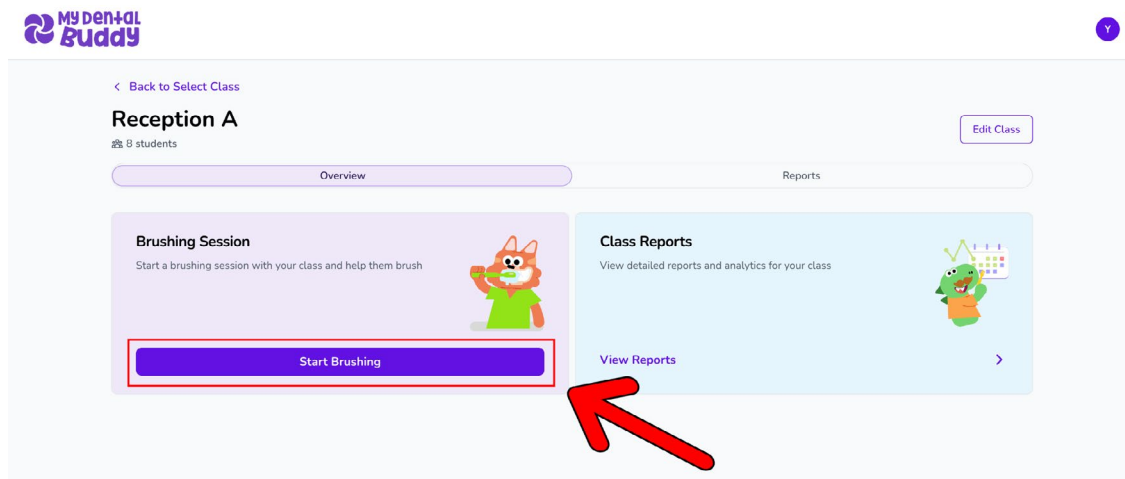

A pop-up will appear, allowing you to adjust the number of students brushing that day.

- Adjust the count to the current number of students and hit “Start Setting Up”

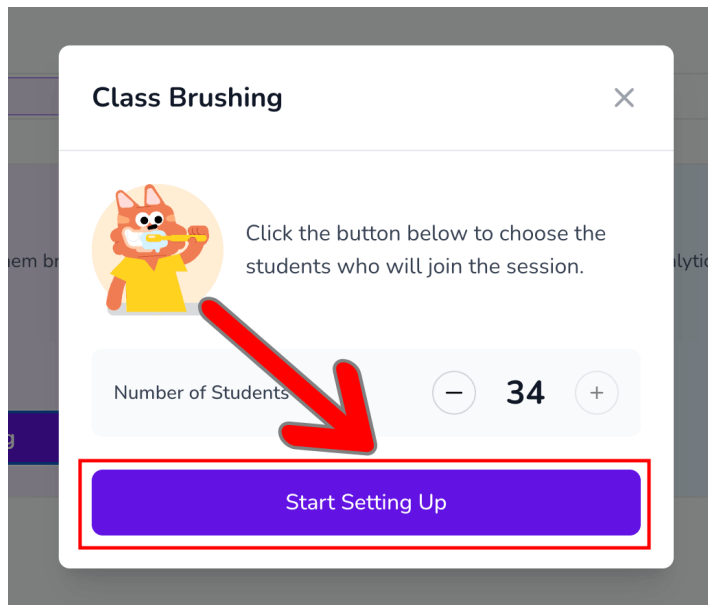

The Setting Up timer will begin alongside a list of setup instructions. The timer will track the number of minutes it takes you to set up the class before the brushing begins.

- Once the class is set up, hit “Continue” to start the Supervised Brushing session.

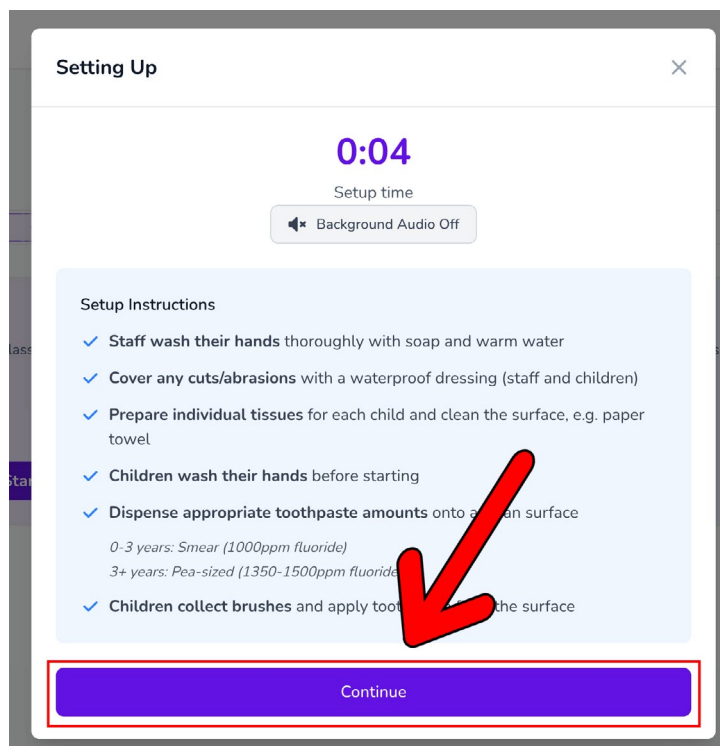

Before the brushing begins, you will have the option to choose our Default video or a YouTube educational brushing video

- Select your preference and hit “Start Brushing Timer”

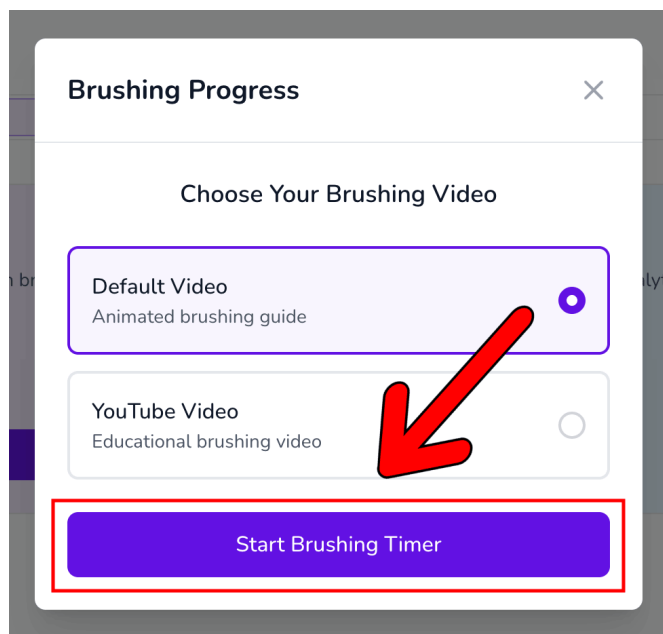

Real Teacher Tip: *“I just quickly count the children, adjust the number, and we’re ready to go. Takes about 10 seconds once you’re used to it.”* - Emma, Year 1

Daily Supervised Brushing - Let's Get Brushing!

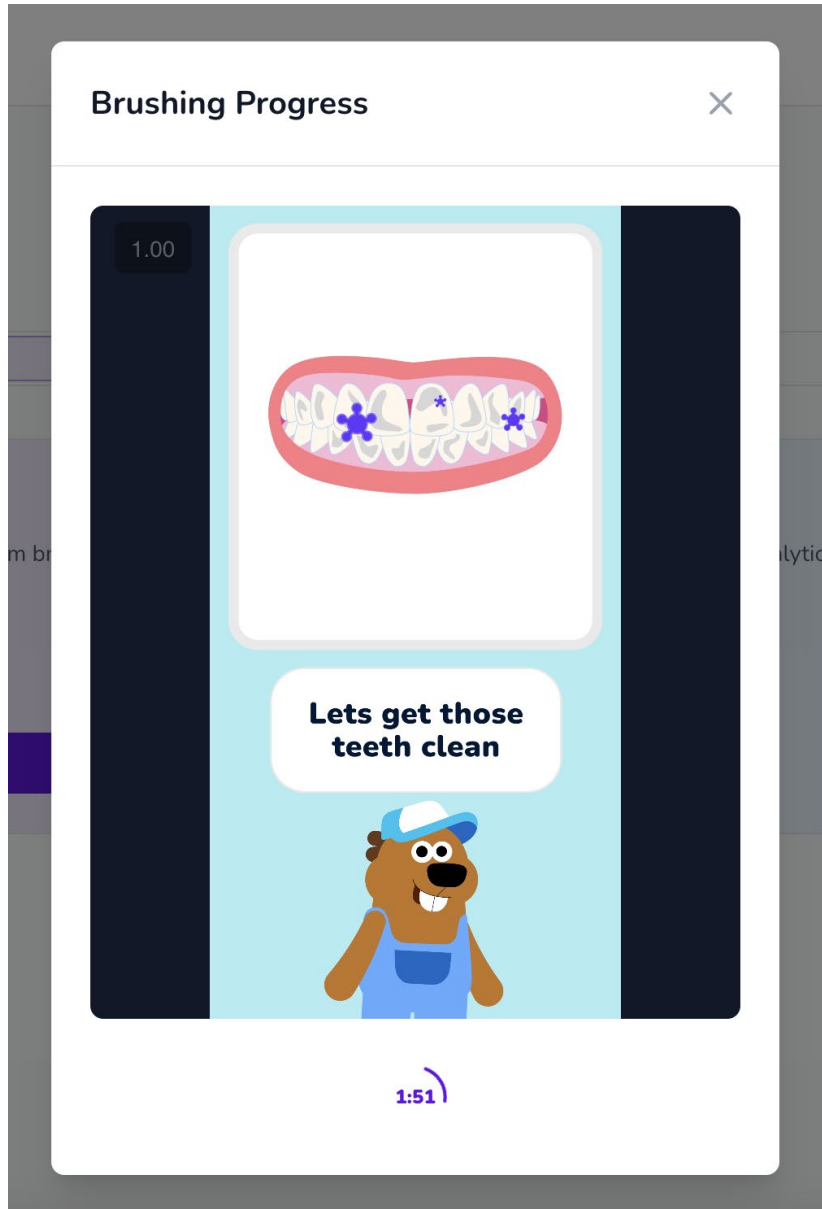

What You'll See:

- Fun animations and characters guide the children
- Step-by-step visual instructions
- A timer showing how long to brush
- Clear prompts for each part of the session

Your Role During the Session:

- Let the video guide the children through each step
- Provide regular supervision and support
- Help any children who need extra assistance
- Enjoy watching the children follow the visual guide!

What Children Love:

- Following the characters on screen
- Seeing the brushing technique demonstrated
- Knowing exactly what to do next
- The fun animations and sounds

Daily Supervised Brushing: Wrapping Up the Session and Cleaning

After the video finishes and the children are done brushing, it's time to conclude the session and start cleaning up.

- Hit “Start Cleaning Up”:

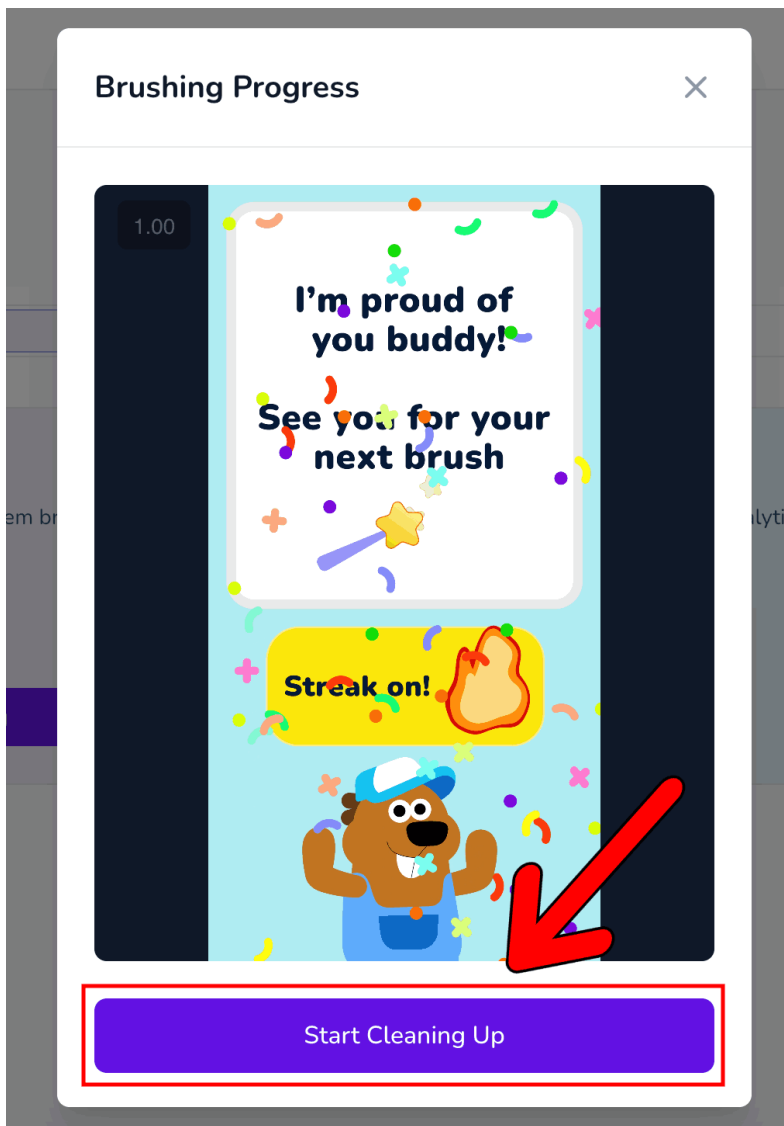

The screen will show a Clean Up timer with all necessary cleaning instructions. Remember, the purpose of the timer is to monitor how long it takes to clean up, helping to improve efficiency over time.

- Follow the cleanup instructions and hit “Finish Brushing” to end the session:

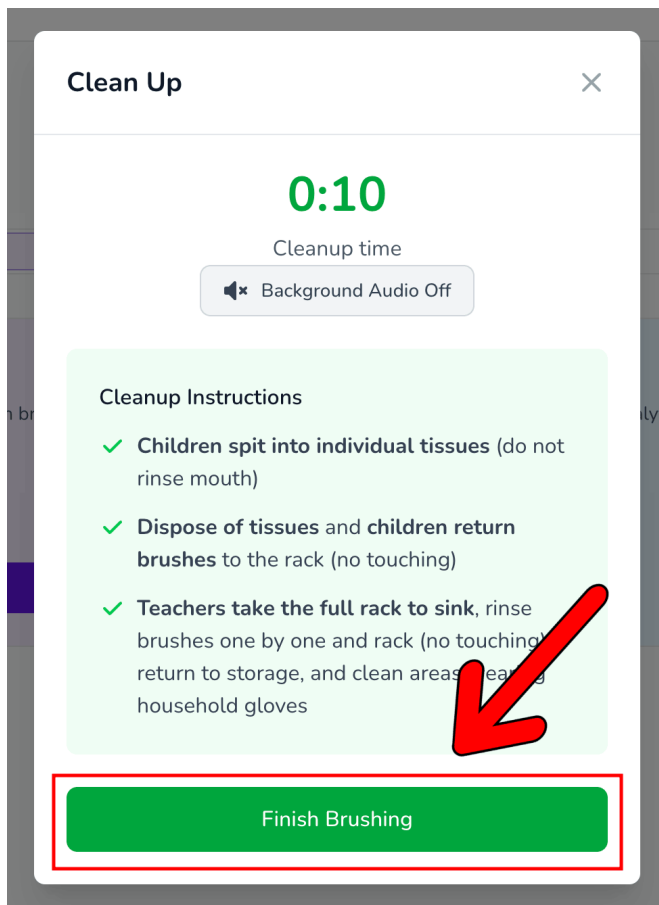

The brushing session will be saved and added to your Class Streak. Additionally, the data will be included in your class report to track efficiency over time.

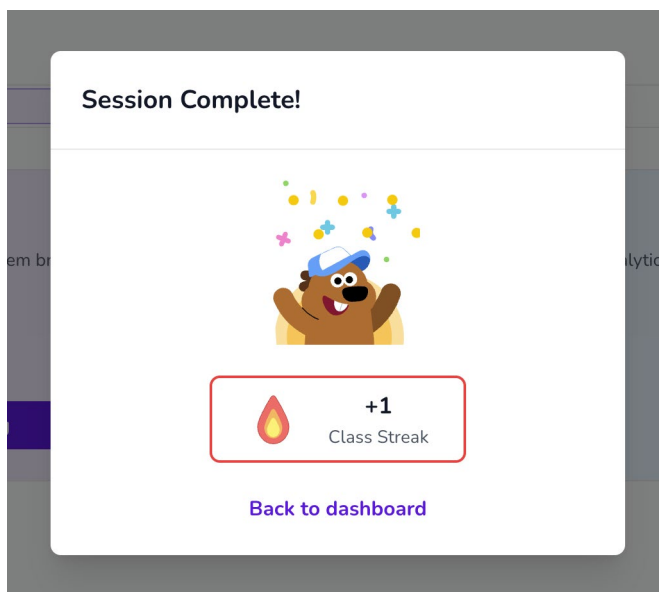

My Dental Buddy

© MDBuddy UK LTD 2025